



# the Lodge at Santa Fe

a Heritage Hotel and Resort



Inspired by the ancient and legendary building traditions of the Anasazi, the Lodge at Santa Fe stands atop the hills of Santa Fe, New Mexico paying tribute to the ancient culture. A blend of Northern New Mexico's distinct cultural influences awaits you at this exquisite Santa Fe style hotel. This 127-room full-service hotel features a number of unique suites, some with wood-burning fireplaces. Relax and enjoy the view from Las Mananitas restaurant or the comfortable hilltop bar and lounge. Just 1 mile to the Historic Santa Fe Plaza, our guests enjoy some of the best shopping and Art markets in the world.

## Accommodations:

Lodge at Santa Fe offers 127 spacious rooms including 25 spacious suites. The guestrooms are some of the most unique rooms in the Southwest. A Navajo Chief's blanket design covers the floor of each room. The furniture is custom designed and handcrafted to reflect hundreds of years of rich Anasazi history and New Mexican heritage.



## Guest Services and Amenities:

- Over 7,000 square feet of meeting and event space
- Intimate wedding chapel
- Complimentary Hi-Speed WIFI
- Some suites with fireplaces
- Las Mananitas restaurant
- Bar and Lounge
- Pet-friendly
- Outdoor pool and hot tub
- Perennial gardens
- Complimentary parking
- Business Center
- Complimentary Shuttle to historic Plaza
- Spa Services Available



## Local Attractions

- Historic Santa Fe Plaza
- Santa Fe Opera
- Museum of Fine Arts
- NM History Museum
- St. Francis Cathedral Basilica
- Palace of the Governors
- Santa Fe Convention Center



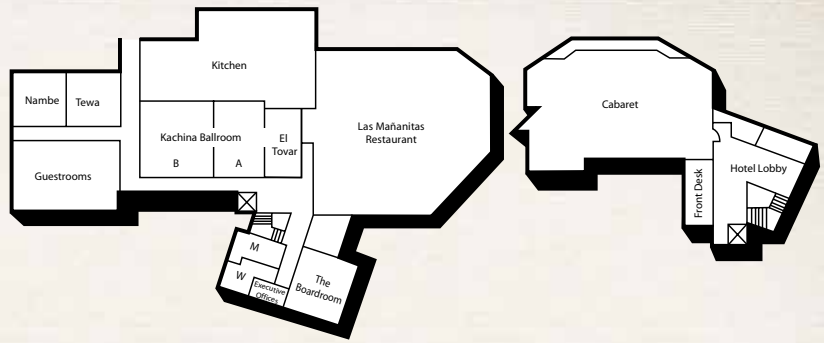

**Kachina Room**

This room offers 2,200 square feet of function space perfect for meeting, conference and banquet events . It can also be divided into two event areas for more smaller groups and meetings.

Seating Capacities:

Kachina Ballroom:	Reception: 250	Theatre: 250	Banquet: 220	Classroom: 150
Kachina A:	Reception: 75	Theatre: 80	Banquet: 60	Classroom: 40
Kachina B:	Reception: 140	Theatre: 140	Banquet: 120	Classroom: 66

**Maria Benitez Theatre**

The Maria Benitez Theatre is an ideal venue offering 2,000 square feet of multi-level meeting and event space with a stage perfect for luncheon or dinner theatre events, corporate award ceremonies, speaker meetings, or live performance space.

Seating Capacities: Reception: 200 Theatre: 150 Banquet: 150

**El Tovar Room**

This room offers 630 square feet of meeting space perfect for smaller meetings or break out sessions.

Seating Capacities: Reception: 50 Theatre: 50 Banquet: 40 Classroom: 30

**Tewa/Nambe Rooms**

These rooms combined offer 1,248 square feet of function space perfect for meeting, conference and banquet events . It can also be divided into two event areas for more smaller groups and meetings.

Seating Capacities:

Combined:	Theatre: 125	Banquet: 100	Reception: 75	Classroom: 70
Tewa or Nambe:	Theatre: 50	Banquet: 40	Reception: 35	Classroom: 35

**The Boardroom**

This room offers 720 square feet of meeting space perfect for smaller meetings.

Seating Capacities: Theatre: 75 Banquet: 60 Reception: 50 Classroom: 45

**Enchanted Perennial Courtyard**

Designed to provide you with breathtaking outdoor event space for parties from 10 to 400 people, this outdoor event area features fabulous perennial gardens, arbors and fountain for an unparalleled outdoor setting for weddings, receptions, reunions and other special events.

Seating Capacities: Reception: 400 Theatre: 350 Banquet: 250

**Chapel- La Capilla de Santa Fe**

Located in the heart of the hotel and just off the perennial courtyard this very intimate nondenominational chapel allows for the perfect Santa Fe destination wedding for up to 40 people theatre style.